

WATER TEST GAUGE



TECHNICAL DATA

Features:

- Helps you plan and design an efficient water-saving irrigation system
- 3/4" thread adapter attaches directly to an outside yard faucet or hose
- Provides accurate pressure readings from 0 to 300PSI
- Clear easy-to-read display in PSI only

Specification:

Dial Diameter:2-1/2"

Range:0-300 PSI

Fitting:3/4" Female

Port Direction:Bottom Mount

PART#	DESCRIPTION
TG-W-HB	HOSE BIBB WATER TEST GAUGE



Country of origin: China

ROUGH IN DR

2.5"	WEIGHT	KEY	A	B	C	D	E	T	W (sq)
		mm	63.5	75	29	61.5	10		3/4" NH
	in	2.5	2.95	1.14	2.42	.39			.55

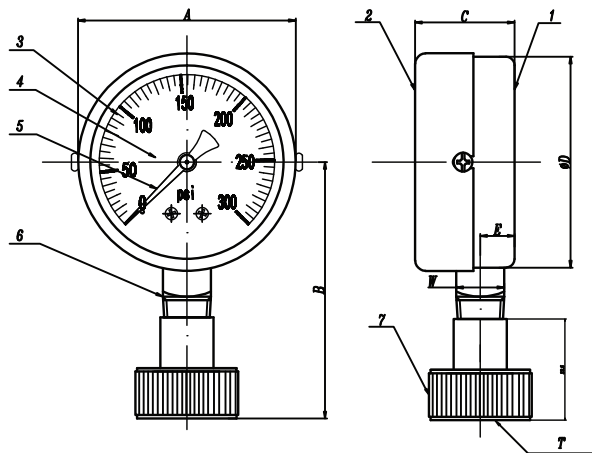

7	Adapter	BRASS
6	Soket	BRASS
5	Pointer	GAVALUME STEEL
4	Window	GLASS
3	Dial	ALUMNUM
2	Ring	IRON
1	Case	IRON
ITEM	NAME	MATERIAL

ALL DIMENSIONS SHOWN ARE NOMINAL